



clients logo

KEY

GROUND FLOOR

WAREHOUSE
Direct delivery area: 57 m²

ANCILLARY AREA
Circulation: 232 m²
Stairs: 51 m²
Lifts: 33 m²
Utilities: 35 m²
Total: 351 m²

Undercroft area*: 1982 m²

Internal walls GIA: 44 m²
Total GF store GIA: 2434 m²

FIRST FLOOR

Sales Area GIA: 1386m²

WAREHOUSE
Warehouse: 339 m²
Bakery freezer: 66 m²
Chillers: 84 m²
Utilities: 35 m²
Total Warehouse GIA: 524 m²

ANCILLARY AREA
Circulation: 227 m²
Bakery preparation: 83 m²
Customer WC: 21 m²
Stairs: 51 m²
Lifts: 33 m²
Welfare: 127 m²
Total: 542 m²

Internal walls GIA: 82 m²
Total FF store GIA: 2534 m²

Total store GIA ex. undercroft: 2986 m²

Site Area: 6269 m²

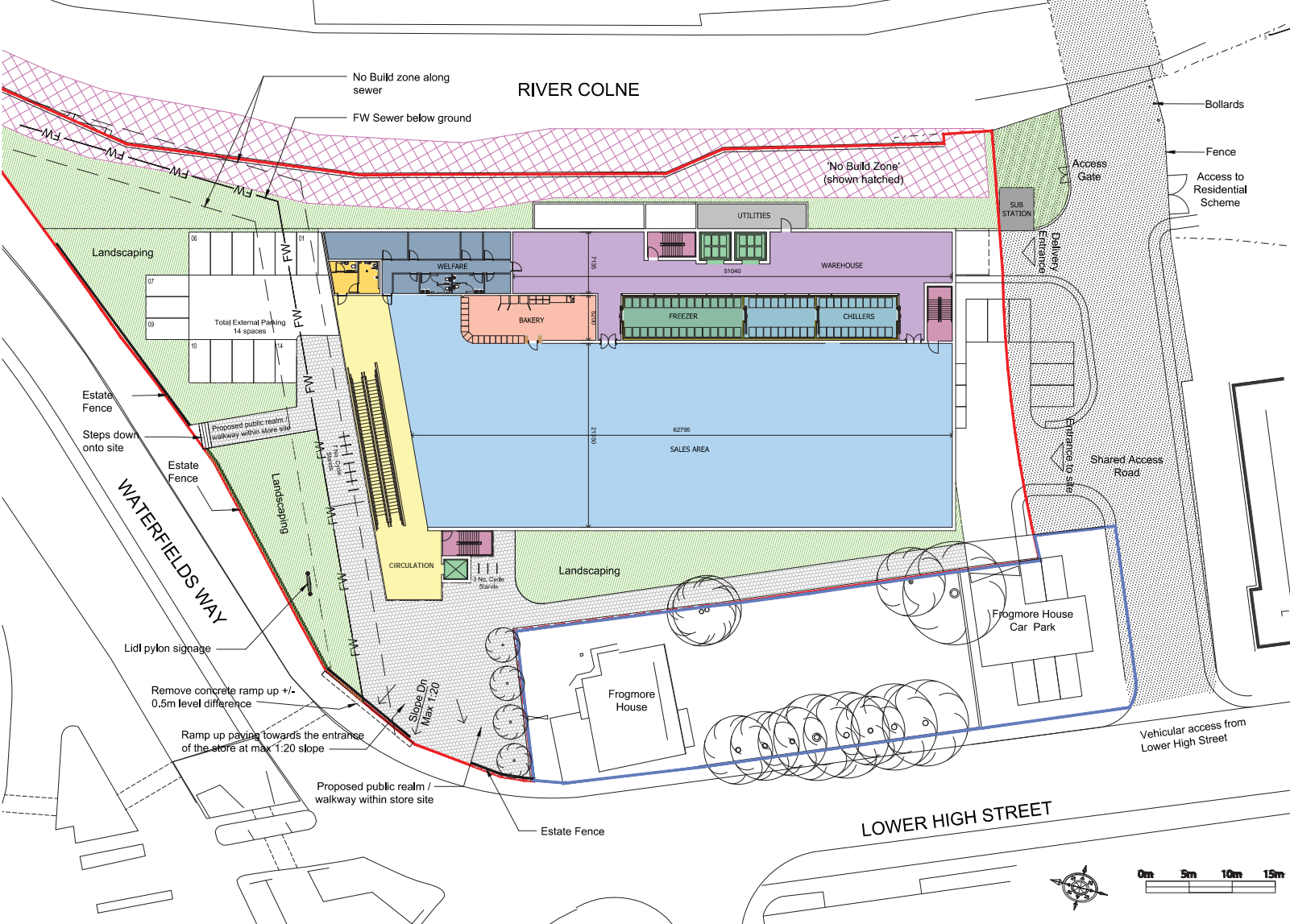

LIDL PARKING

Standard Parking:	82 Spaces
Disabled Parking:	6 Spaces
Parent & Child Parking:	4 Spaces
Total Parking:	92 Spaces
Cycle stands:	22 Spaces

- Excludes Frogmore House Parking
- Public Realm and Pedestrian Passage Way
 - Shared Access Road
 - No Build Zone

E	28.04.17	Amended to client's comments	AW
D	27.04.17	Amended to client's comments	AW
C	10.04.17	Sub Station added & associated landscaping	SG
B	31.03.17	Building moved 2m east	SG
A	28.03.17	External plant area moved, utilities post added	SG
REV	DATE	DESCRIPTION	BY

IN CASE OF DISPUTE OR DISCREPANCIES PLEASE REFER TO ARCHITECT FOR INSTRUCTIONS.
DRAWING AND SUITABILITY NUMBERS IN ACCORDANCE WITH BS1193:2007.
THIS DRAWING IS UNLESS NOTED OTHERWISE.
THIS DRAWING IS COPYRIGHT.

SUITABILITY NUMBER KEY:

WIP	Work in Progress*	DOCUMENTATION: SIGN-OFF
SHARED		A - Fit for construction
S1	Fit for co-ordination**	B - Fit for construction, with comments
S2	Fit for information	C - Comprehensive revisions needed
S3	Fit for internal review and comment	ARCHIVE
S4	Fit for construction approval	A3 - As Built
DOCUMENTATION		FC - Final Construction
D3	Fit for costing	** For internal pre-issue usage only.
D2	Fit for tender	** For model file usage only.
D3	Fit for contractor design	
D4	Fit for manufacture/procurement	

4th Floor, Greyfriars House
Greyfriars Road, Cardiff CF10 3AL
Tel: 029 2055 8900 Fax: 029 2039 9592
www.boyesrees.co.uk
Registered office: As above Reg No 295 1683 (England & Wales)

PROJECT TITLE:
Proposed Lidl store at Lower High Street, Watford, WD17 2HX

DRAWING TITLE:
Proposed Site Plan - Option 1 First Floor

DRAWN BY: SG SCALE: 1:500 @ A3
JOB NO: 5644 DATE: DEC 2016

SUITABILITY:	SO	REVISION:	E			
PROJECT	ORIGIN	VOLUME	LEVEL	TYPE	DISCIP	NUMBER
5644	BR	V01	01	DR	A	010101

FIRST FLOOR PLAN
SCALE 1:500



Copyright © 2016 by Boyes Rees & Partners LLP. All rights reserved. No part of this document may be reproduced without the prior written permission of Boyes Rees & Partners LLP.